

Private & Companion Monthly Fees

MONTHLY SERVICE FEE FOR SUITES:

Private	\$5500.00
Companion	\$4500.00
Security Deposit (non-refundable)**	\$1500.00 nR-
Respite Care	\$200.00/day

The following is included in the Monthly Service Fee for all suites:

24/7 Staffing, 24 Hour Security, Emergency Response System, Medication Reminders, Dining, Housekeeping and Laundry, Daily Activities, Utilities (excludes telephone), Maintenance and Repairs.

CARE LEVELS:

Care Levels are based on scores obtained from the Functional Needs Assessment. This assessment is performed prior to taking residency, after 30 days and annually thereafter. Additional re-assessments will be performed at any time there is a significant change in the resident's condition.

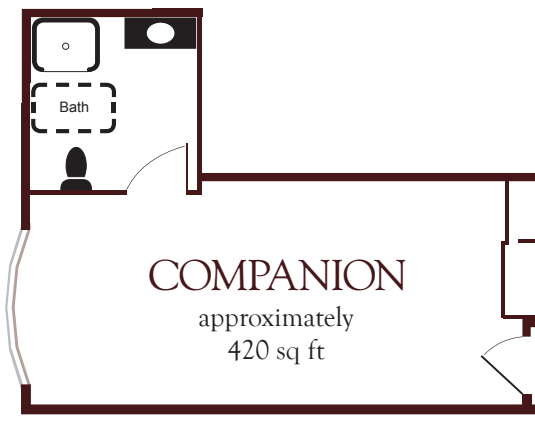
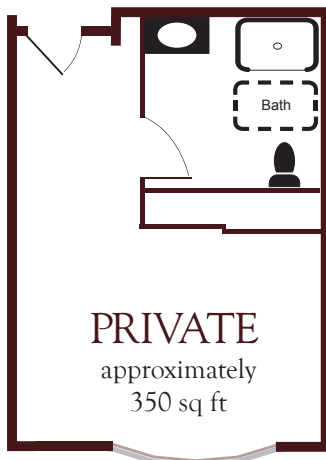

Chandler
MEMORY CARE

Our Comprehensive Program

OUR ASSOCIATES

Every associate who works in this special community first completes a comprehensive training program that focuses on appropriate ways to communicate and care for people with memory impairments. Ongoing in-service and training for associates, as well as support-group meetings for families, are led by Alzheimer's-trained professionals from our local community.

PEACE OF MIND

The safety and security of our residents is a top priority. We have a system designed to ensure peace of mind for residents and their families.

- Emergency Call Systems in Each Suite
- Interior and Exterior Video Surveillance
- State-of-the-Art Fire System
- Support Bars and Handrails
- Highly Trained Support Staff

WE UTILIZE THE "BEST FRIENDS" APPROACH TO CARE

- Caregivers Use Life Story
- Builds Trust/Friendships
- Individualized Care



Because Memories Matter

Services & Amenities

Our services are delivered by compassionate, caring, and skilled individuals. To ensure an accurate evaluation of the assistance needed, we use an in-depth, computer driven assessment tool along with input from the resident and family, to develop a personalized service plan. Once the initial assessment is complete, we will generate a service plan; create individual schedules to provide better delivery of services; and provide a method of accountability.

SERVICES:

- Bathing
- Dressing
- Grooming
- Medication Assistance
- Restaurant Style Meals & Snacks Served Daily
- Transfer Assistance
- Housekeeping
- Laundry
- Escorting
- Incontinence Care
- Maintenance
- Individual & Group Activities
- Annual Functional Needs Assessments
- Family Support Groups
- Hydration Program

AMENITIES:

- Fully Furnished Suites
- Activity Kitchen
- Secured Outdoor Gardens
- Cable TV
- Beautifully Landscaped Walking Paths
- Pharmacy Delivery Service
- Secured Facility

ACCESS TO:

- 3rd Party Medical Services
- Spacious Dining Room
- Beauty Salon
- Laundry Service
- Recreation & Activity Areas

Our Life Enrichment & Dining Program

LIFE ENRICHMENT CENTER

Our Life Enrichment Center uses a variety of engaging activities to entertain and keep our residents engaged in life mentally, physically, and socially. We work closely with families to learn about treasured memories and past experiences. Together, we develop a unique program that embraces their current abilities, promotes confidence and builds self-esteem. Our Life Enrichment Center is one part of our commitment to help ease the sense of forgetfulness, loss, and frustration that accompany a memory deficit.

OUR DINING PROGRAM

We recognize the need to maintain each resident's ability to enjoy and master the dining experience. Our dining program offers several special aspects:

- Dementia Friendly Menus
- Dining Assistance
- Consistent Seating to Promote Familiarity and Socialization
- Therapeutic Finger Food Menu Options
- Plate Prep to Preserve Dignity
- Nutritional Snacks Offered Throughout the Day

We recognize the foundation of a healthy lifestyle must begin with delicious, well-balanced, and nutritious meals. Our menus represent a combination of our residents' preferences, our skilled dietary staff, and a few pleasant surprises. Our residents enjoy wonderful home-cooked meals in a comfortable, inviting dining room and, of course, guests are always welcome.